

# TYPE B

## Ref.: 156128



ISO/PAS 11154



CITY CRASH TEST



# n° 128



Citroen Aircrosser	5	04/2012->
Kia Cee'd	3/5	12/2006->05/2012
Kia Cee'd	3/5	05/2012->
Hyundai i30	3/5	09/2007->05/2012
Hyundai i30	3/5	05/2012->
Mazda 2	3/5	10/2007->
Mazda 3	3/5	02/2004->06/2009
Mazda 3	3/5	06/2009->
Mazda 5	5	01/2010->
Mazda 6	4/5	08/2007->
Mazda CX-5	5	03/2012->
Mazda CX-7	5	01/2007->
Mitsubishi Asx	5	07/2010->
Mitsubishi Lancer	5	02/2008->
Mitsubishi Lancer Evo X	5	02/2008->
Peugeot 4008	5	05/2012->

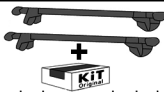

**5 kg + xx Kg = 75 kg max**

Ne pas dépasser la charge maximale des barres. Ne pas dépasser la charge maximale indiquée par le constructeur du véhicule  
 Non superare il carico massimo delle barre portatutto. Non superare il carico massimo indicato dal costruttore del veicolo  
 Carga máxima admisible indicada en la caja de las barras de techo. No exceda la carga máxima permitida por el fabricante del vehículo.  
 Maximum allowable load indicated on the box of roof bars. Do not exceed the maximum load allowed by the vehicle manufacturer.  
 Maximal zulässige belastung angegeben auf der box der dachreling. Überschreiten sie nicht die maximale belastung durch den fahrzeughersteller zugelassen.

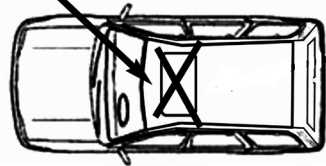
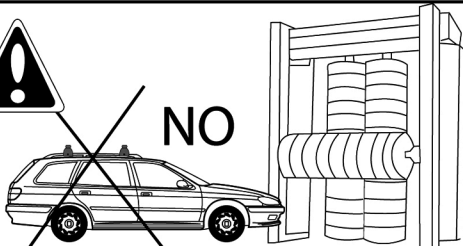
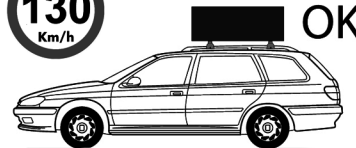
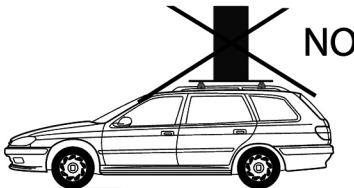
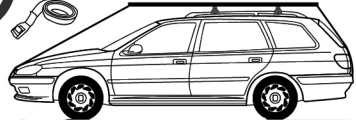
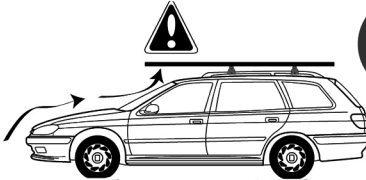

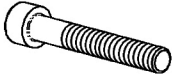
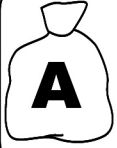

4762.616

**x8**



6592.06

**x8**

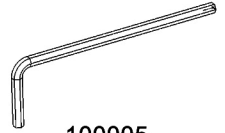

100005

**x1**



7474.06

**x4**



6593.06

**x4**

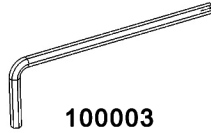

100003

**x1**



4026.655

**x4**

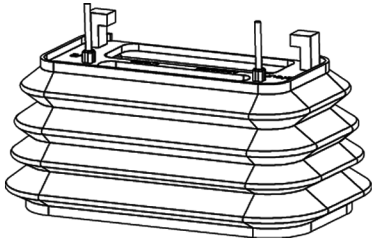

**x4**

81003

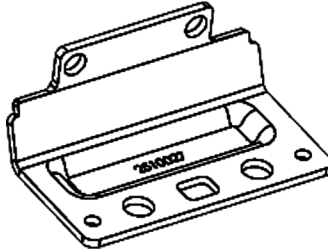

**x4**

2510027

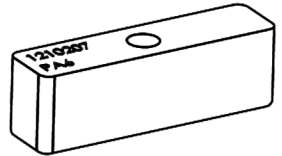

**x4**

1210207



**x1**

10013ZG



**x8**

1512407



	X	Y
Citroen Aircross	87 Cm	81,5 Cm
Hyundai i30	81,5 Cm	78,5 Cm
Hyunda i30 II	78 Cm	72,5 Cm
Cee'd	81,5 Cm	78,5 Cm
Kia Cee'd II*	78 Cm	72,5 Cm
Mazda 2 II	76,5 Cm	68 Cm
Mazda3 I	82,5 Cm	79 Cm
Mazda 3 II	82,5 Cm	79 Cm
Mazda 5	80 cm	80 cm

	X	Y
Mazda6	80 cm	80 cm
Mazda CX-5	85 Cm	80 Cm
Mazda CX-7	89,5 Cm	85 Cm
ASX	87 Cm	81,5 Cm
Mitsubishi Lancer	85 Cm	85 Cm
Mitsubishi Lancer Evo-X	85 Cm	85 Cm
Peugeot 4008	87 Cm	81,5 Cm

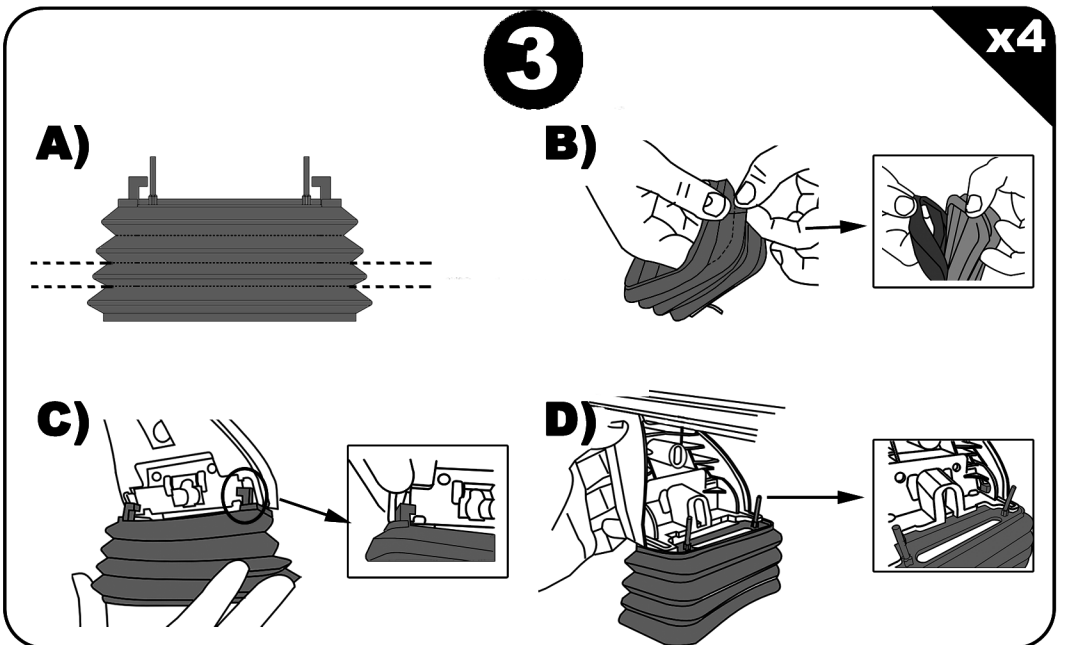
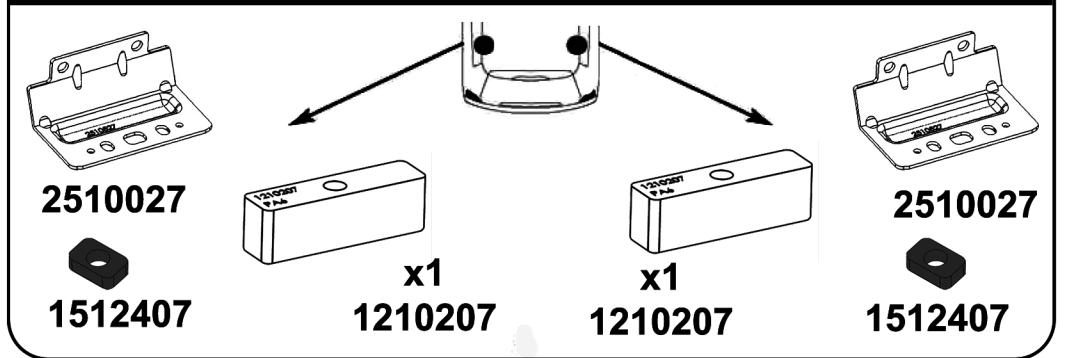
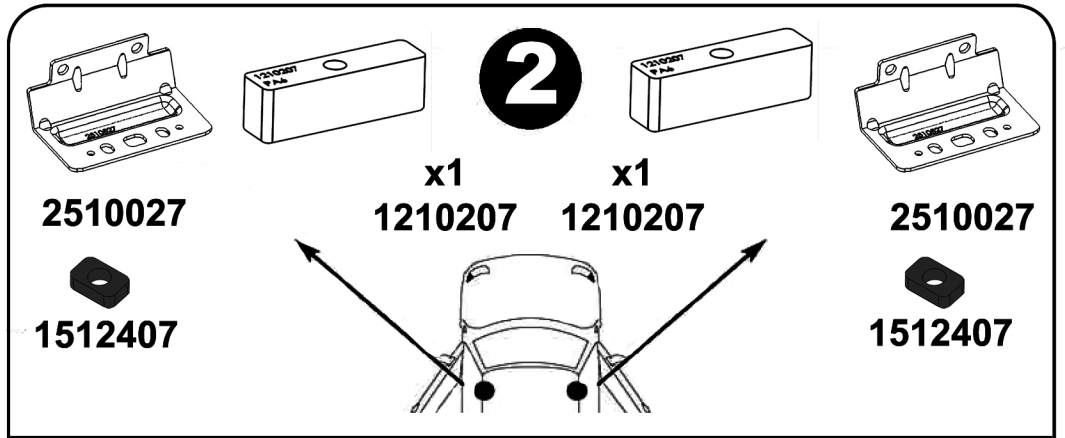

# 4

x4

A)

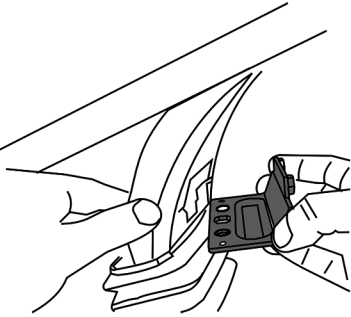

B)

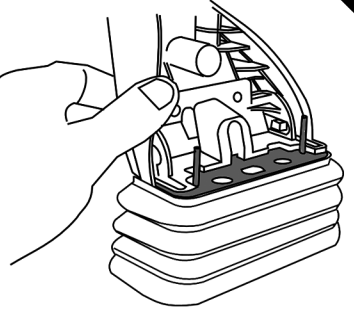

C)

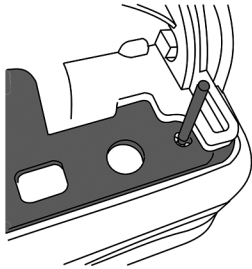

D)

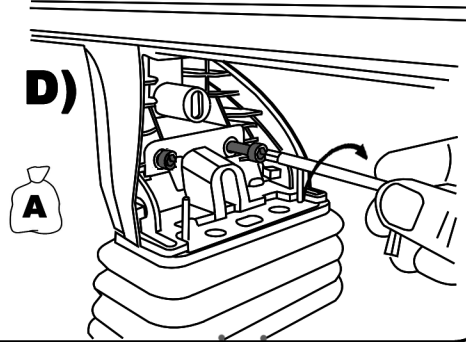

# 5

x2

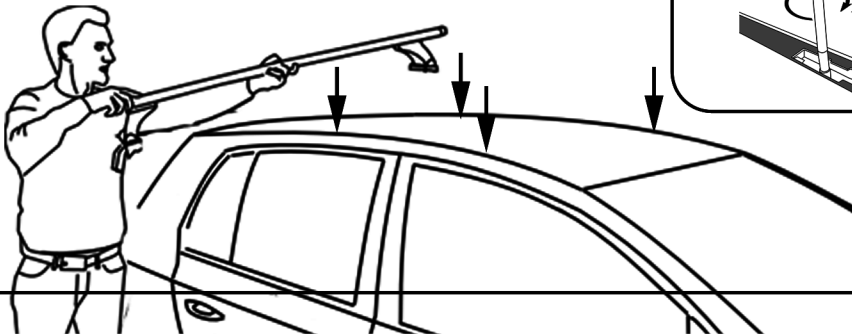
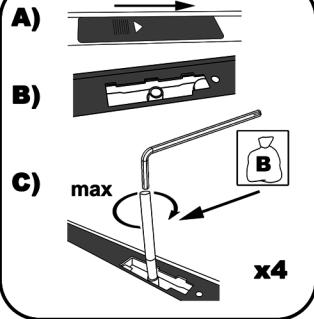

**6**

**x4**

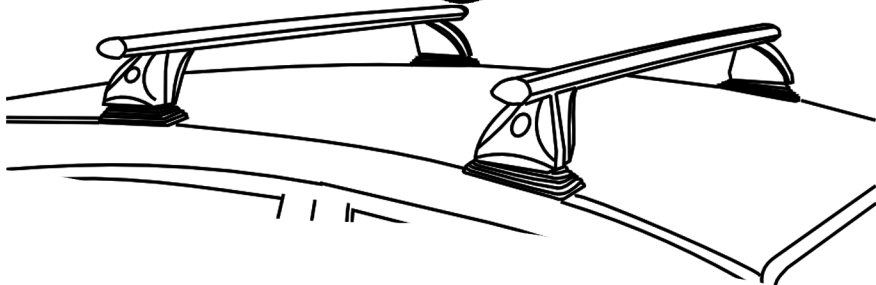

**D1)**

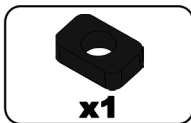
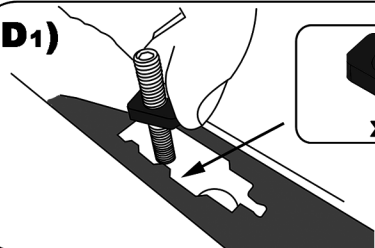

**x1**

**x4**

Kia Cee'd	12/2006->05/2012
Hyundai i30	09/2007->05/2012
Mazda 2	10/2007->
Mazda 3	02/2004->06/2009
Mazda 3	06/2009->
Mazda 5	01/2010->
Mazda 6	08/2007->
Mazda CX-5	03/2012->
Mazda CX-7	01/2007->

**D2)**

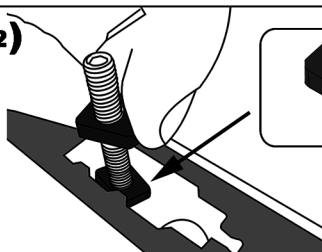

**x2**

**x4**

Kia Cee'd	05/2012 ->
Hyundai i30	05/2012 ->

**D3)**

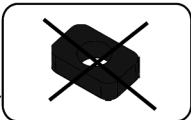
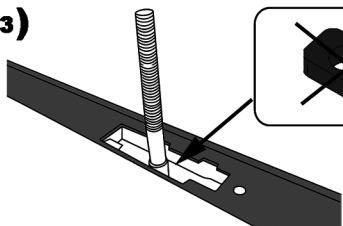

**x4**

Citroen Aircrosser	05/2012->
Mitsubishi ASX	07/2010->
Mitsubishi Lancer	02/2008->
Mitsubishi Lancer evo X	02/2008->
Peugeot 4008	05/2012->

**7**

**x4**

**A)**

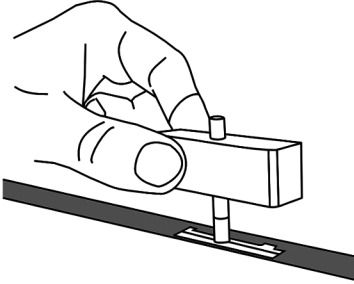

**B)**

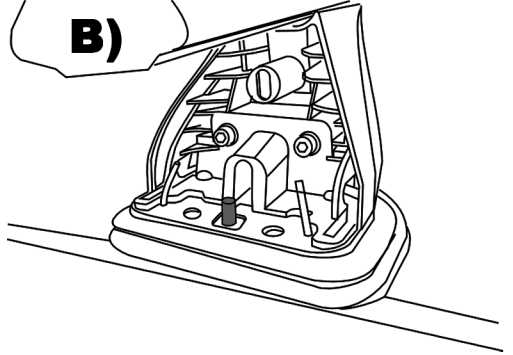

**C)**

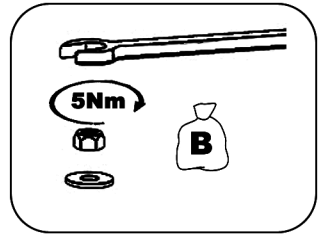
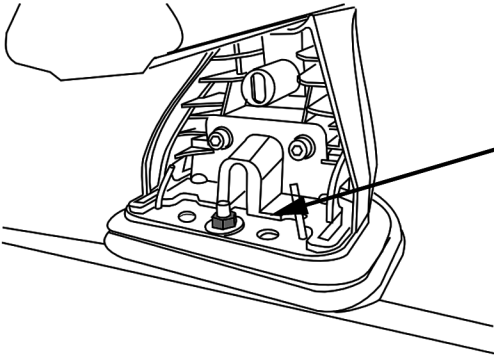

**D)**

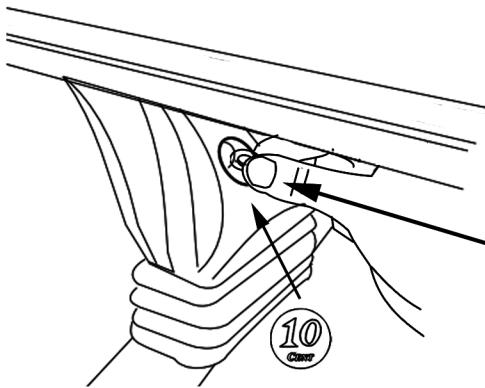

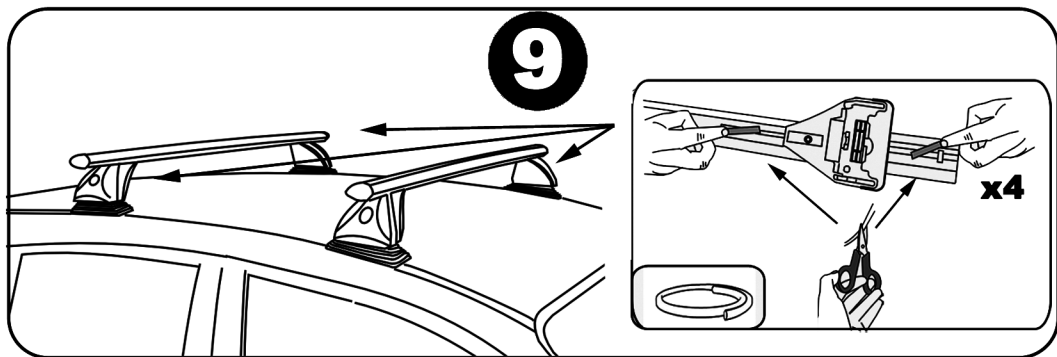
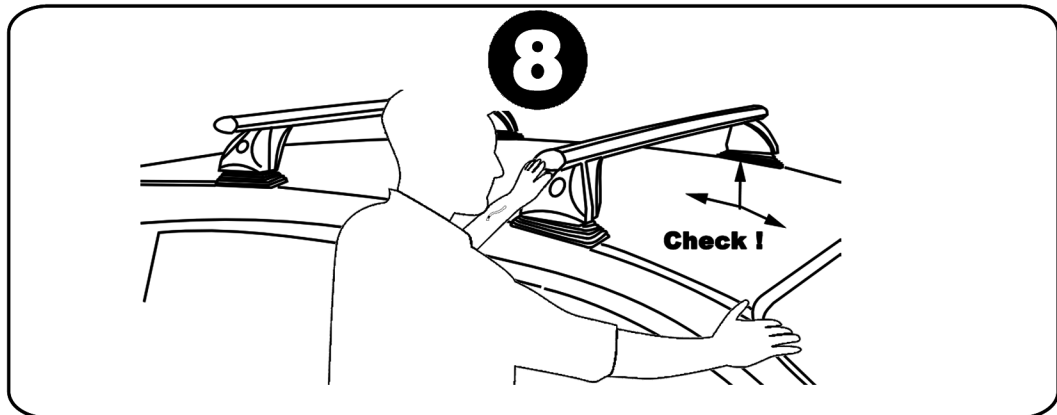

**FR:** Charge maxi 75 kg ne pas dépasser la charge maximale admissible par le constructeur du véhicule.  
**IT:** Carico massimo 75 kg non superare il carico massimo sul tetto indicato dal costruttore del veicolo  
**SP:** Capacidad máxima de carga 75 kg no exceda la máxima carga permitido por el fabricante del vehículo.  
**PT:** Capacidade máxima de carga 75 kg não exceder a carga máxima permitida pelo fabricante do veículo.  
**EN:** Maximum carrying capacity 75 kg do not exceed the maximum allowable load by the vehicle manufacturer.  
**DE:** Zulässige höchstlast 75 kg überschreiten sie nicht die maximale belastung zulässige vom fahrzeughersteller.  
**NL:** Maximaal toegestaan 75 kg neem niet meer de maximale belasting toegestane door de voertuigfabrikant.

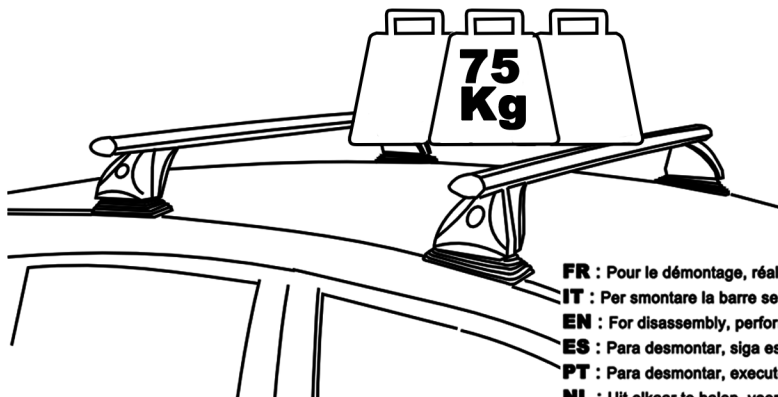

**FR :** Pour le démontage, réaliser à l'inversement ces étapes.  
**IT :** Per smontare la barre seguire le fasi al contrario .  
**EN :** For disassembly, perform these steps in reverse.  
**ES :** Para desmontar, siga estos pasos a la inversa.  
**PT :** Para desmontar, execute estas etapas em ordem inversa  
**NL :** Uit elkaar te halen, voert u deze stappen in omgekeerde.  
**DE :** Zu zerlegen, diese Schritte in umgekehrter