

TYPE A

Ref.: 156235



ISO/PAS 11154



CITY CRASH TEST



n° 235



Nissan Qashqai

5

02/2007->



5 kg + xx Kg = 75 kg max

Ne pas dépasser la charge maximale des barres. Ne pas dépasser la charge maximale indiquée par le constructeur du véhicule

Non superare il carico massimo delle barre portatutto. Non superare il carico massimo indicato dal costruttore del veicolo

Carga máxima admisible indicada en la caja de las barras de techo. No exceda la carga máxima permitida por el fabricante del vehículo.

Maximum allowable load indicated on the box of roof bars. Do not exceed the maximum load allowed by the vehicle manufacturer.

Maximal zulässige belastung angegeben auf der box der dachreling. Überschreiten sie nicht die maximale belastung durch den fahrzeughersteller zugelassen.

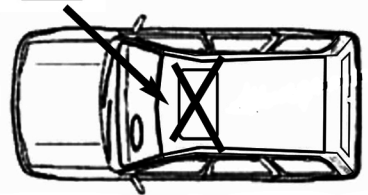
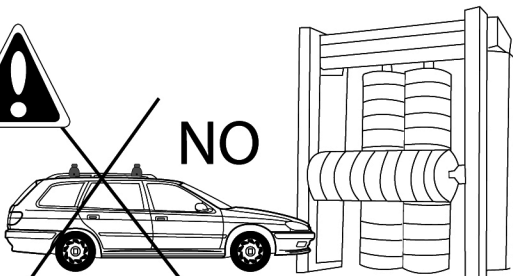
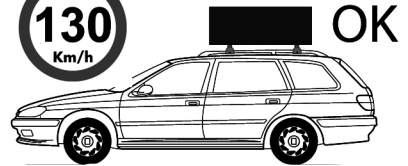
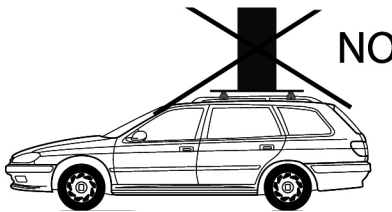
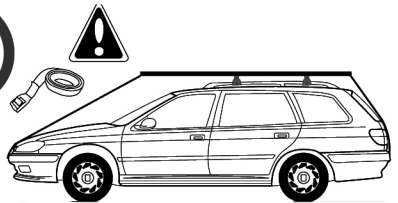
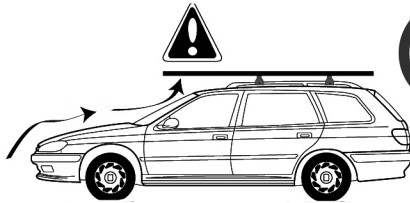

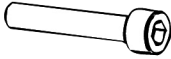

M6x50
x4

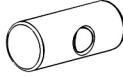

162100001
x4



659106
x4



100005
x1



M5x12



7687512
x4



100003
x1

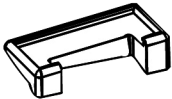

x1
1123501

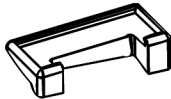

x1
1123502

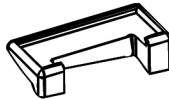

x1
1123503

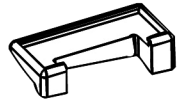

x1
1123504



235A



235B



235C



235D

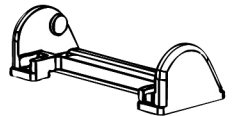

x4

214800001

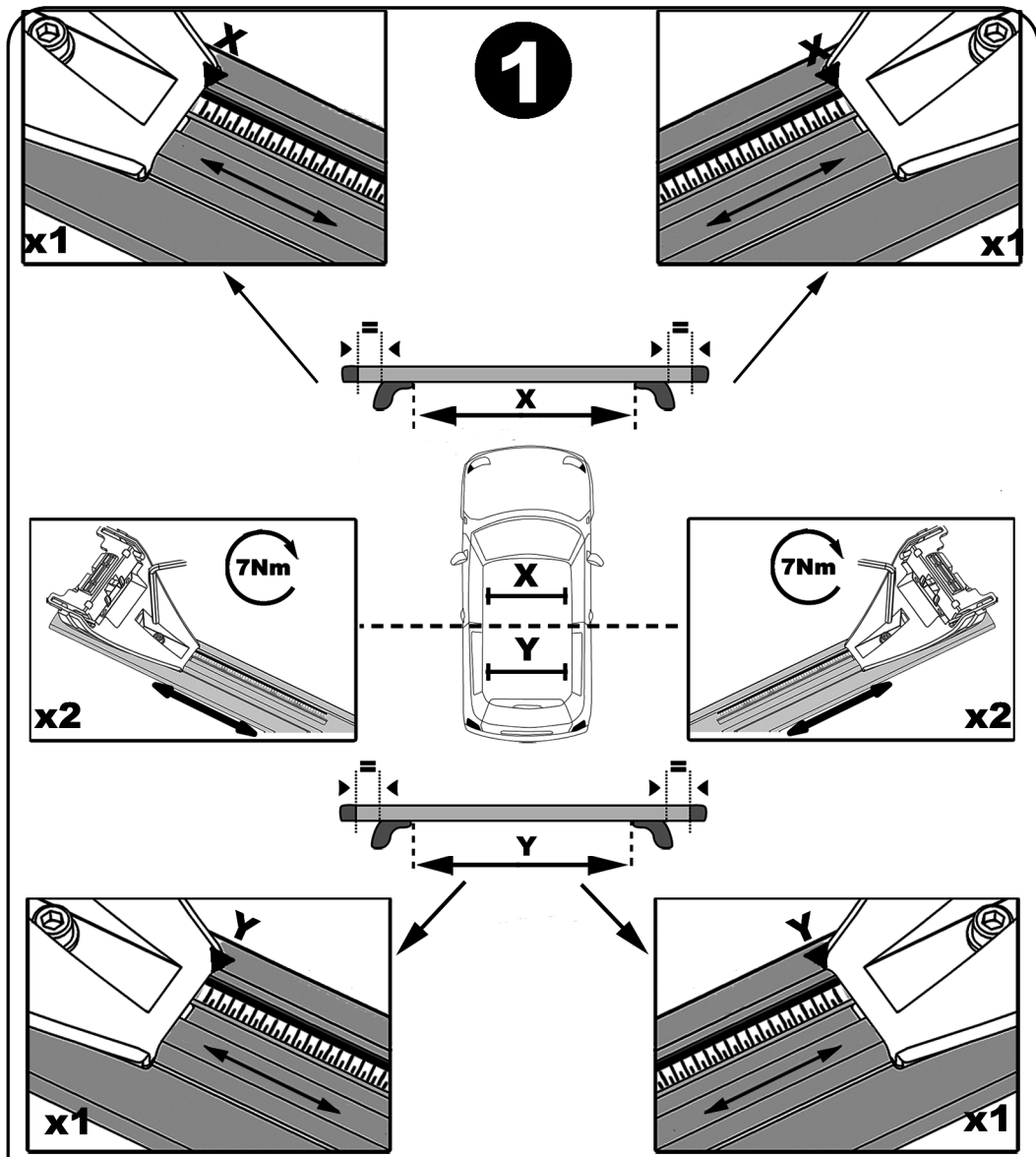

	X	Y
Nissan Qashquai	95 cm	92,5 cm

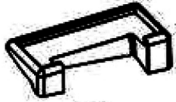

1123501



x1
235A

2

x1
235B

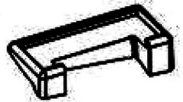

1123502

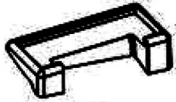
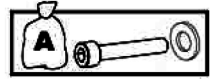
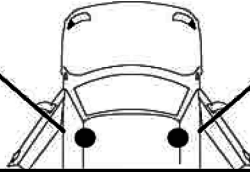
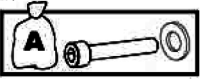

1123503



x1
235C



x1
235D

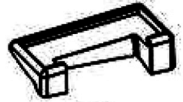

1123504

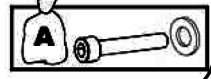
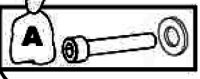

3

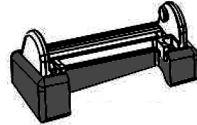
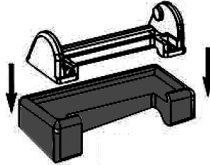
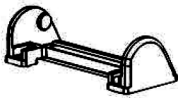

x4

4

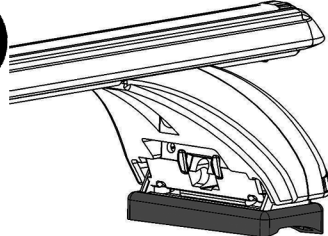
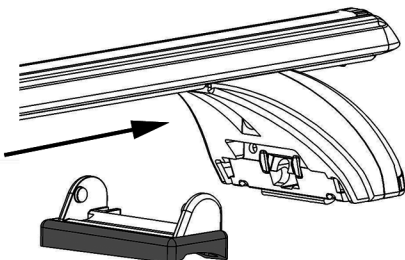

x4

5

x4

A)

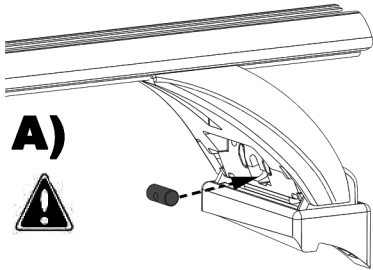

B)

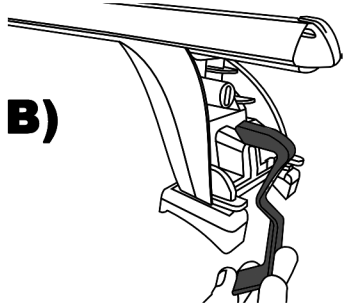

C)

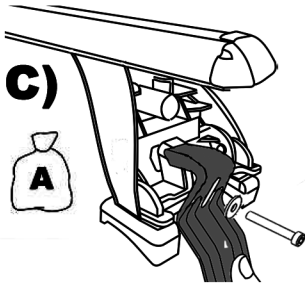

D)

x2

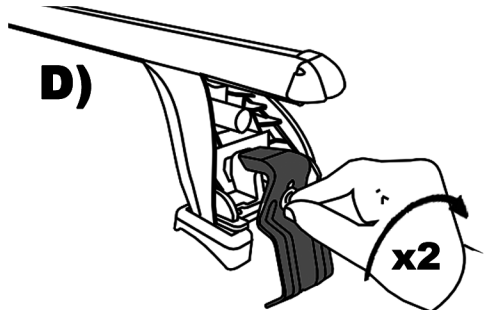

6

x2

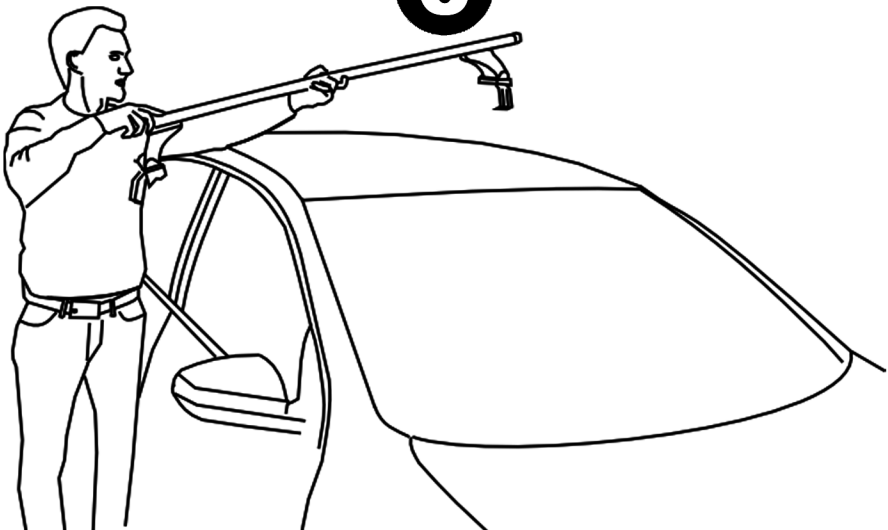

7

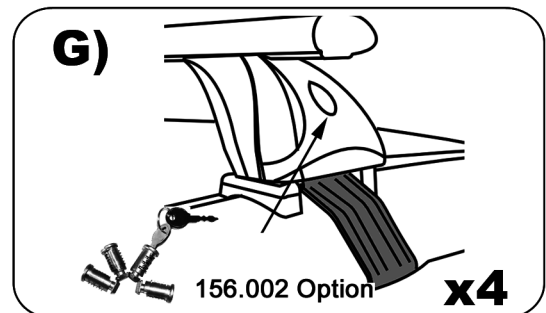
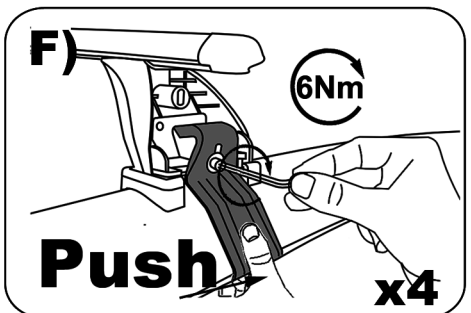
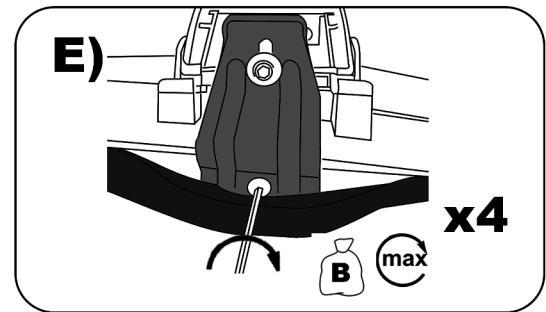
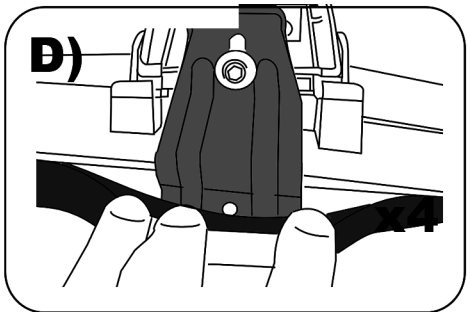
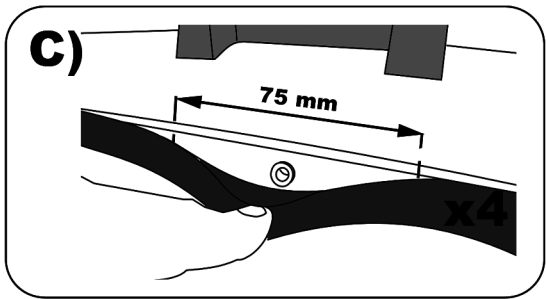
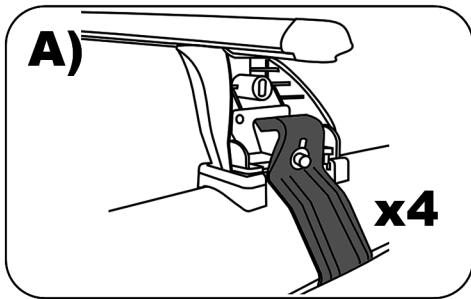
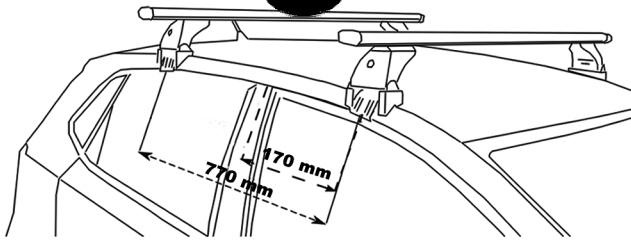

F Serrer alternativement chaque côté
E Alternare il serraggio delle viti
I Serrare alternativamente
P Aperte alternadamente
GB Tighten alternately
D Die Schrauben abwechselnd anziehen

NL Afwisselend aan de linker en de rechterkant aandraaien
S Dra åt växelvis
FIN Kierrä vuorotellen
EST Pinguldage vaheldumisi
LAT Pievelciēt pamāšus
LIT Uzsukinėkite pakaitomis
PL Śrubę dokrecaj naprzemiennie

CZ Pokretla bagaznika dokrecaj dokrecaj naprzemiennie
SK Dotahujte striedavo
SLO Privijajte izmenicno
HR Naizmjerno zategnite
HU Egymástól függetlenül szorítandó
TR Donüşümlü sıkın

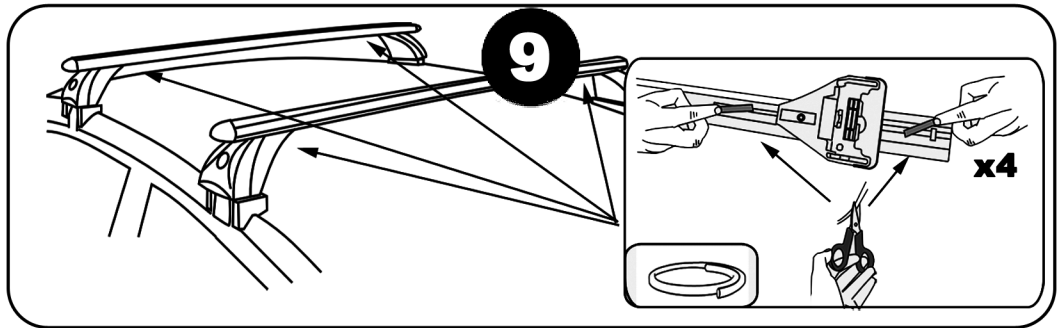
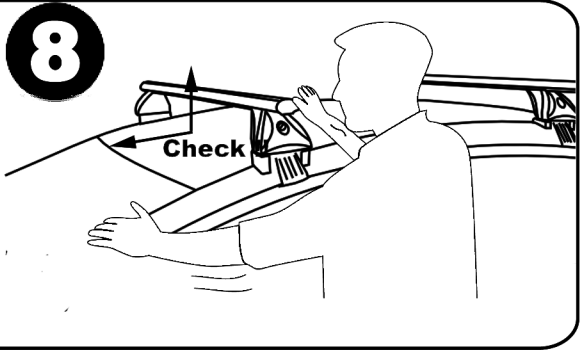
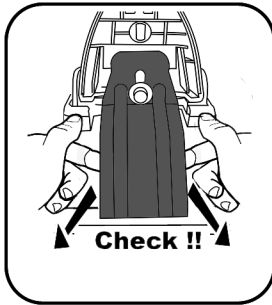

Démontage - Desmontaje - Smontaggio - Desmontagem - Disassembly - Demontage

