

# TYPE A

## Ref.: 156266



ISO/PAS 11154



CITY CRASH TEST



# n° 266



**Toyota Rav4 III ( no rails)**

**5**

**12/2006->01/2013**

**Toyota Rav4 IV ( no rails)**

**5**

**01/2013->**



**5 kg + xx Kg = 75 kg max**

Ne pas dépasser la charge maximale des barres. Ne pas dépasser la charge maximale indiquée par le constructeur du véhicule

Non superare il carico massimo delle barre portattuto. Non superare il carico massimo indicato dal costruttore del veicolo

Carga máxima admisible indicada en la caja de las barras de techo. No exceda la carga máxima permitida por el fabricante del vehículo.

Maximum allowable load indicated on the box of roof bars. Do not exceed the maximum load allowed by the vehicle manufacturer.

Maximal zulässige belastung angegeben auf der box der dachreling. Überschreiten sie nicht die maximale belastung durch den fahrzeughersteller zugelassen.

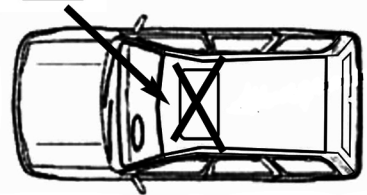
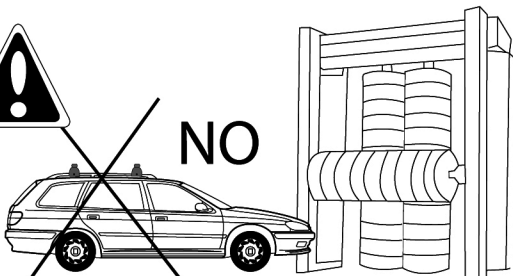
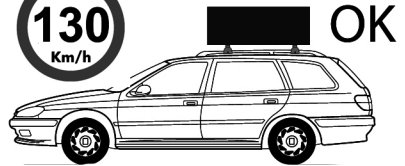
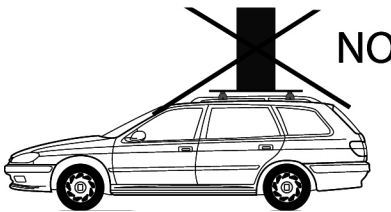
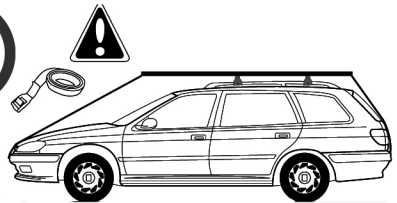
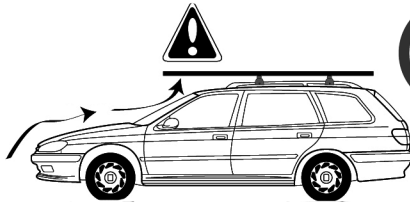

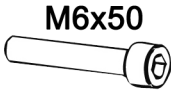

M6x50  
4762.650  
x4

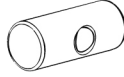

162100001  
x4



659106  
x4



100005  
x1

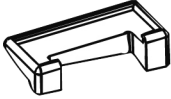

x1  
1122501

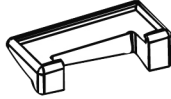

x1  
1122502

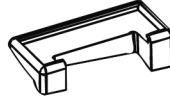

x1  
1122503

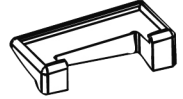

x1  
1122504

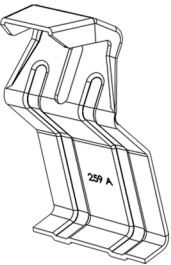

259A  
x2



259B  
x2

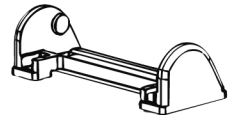

214800001  
x4

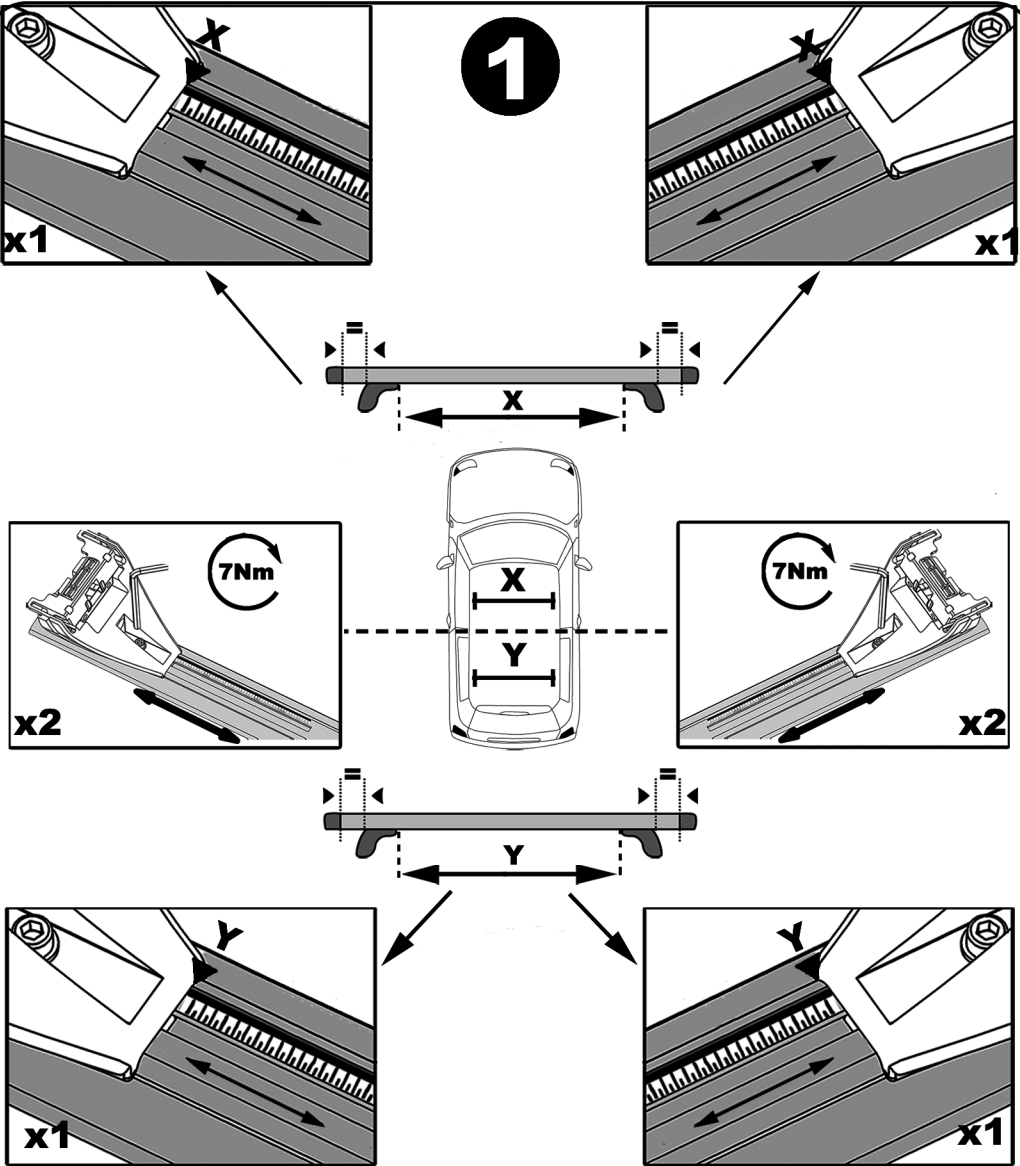

	X	Y
Toyota Rav 4 07->13	92 cm	90,5 cm
Toyota Rav 4 13->	92,5 cm	91 cm

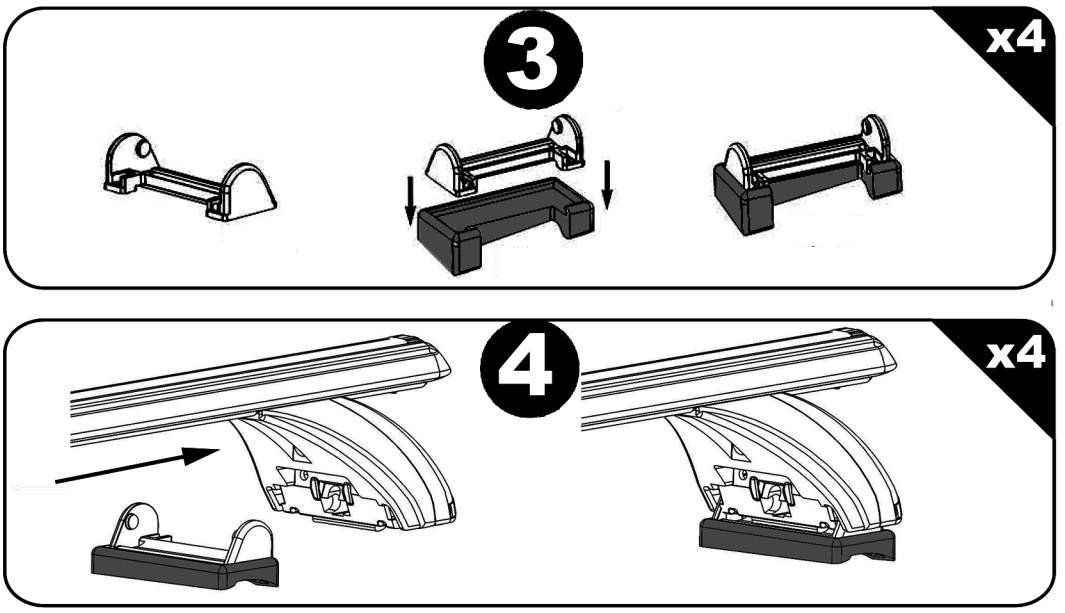
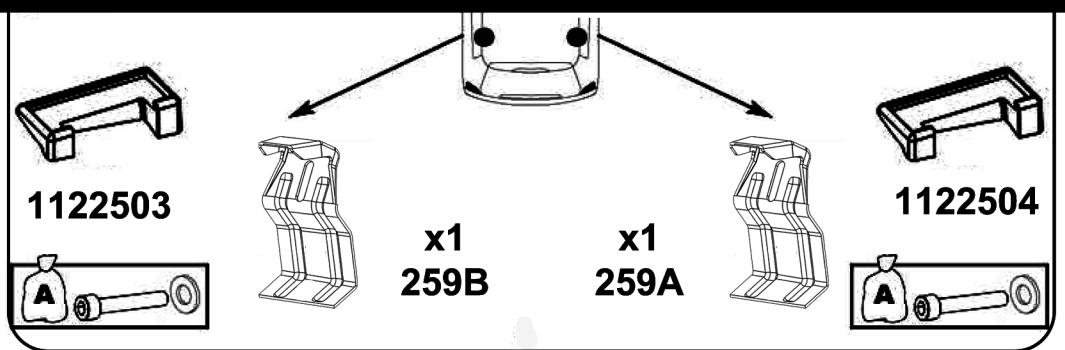
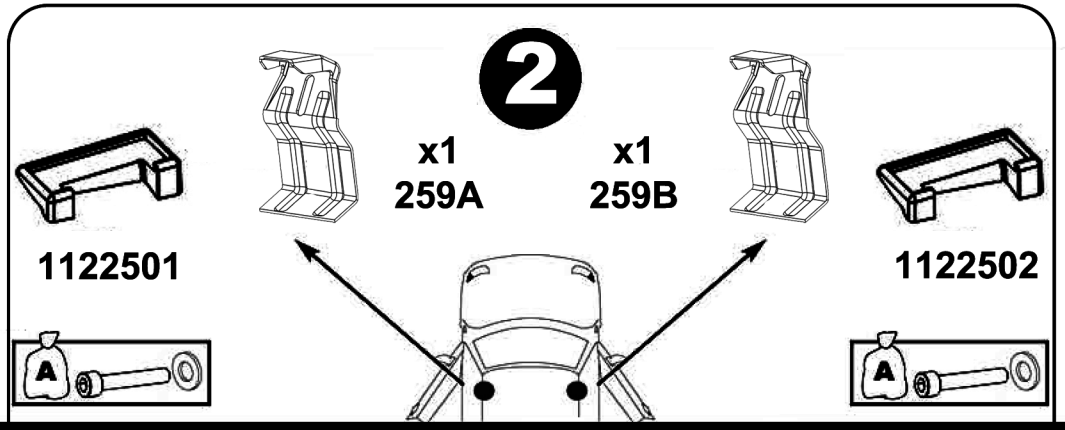

**5**

**x4**

**A)**

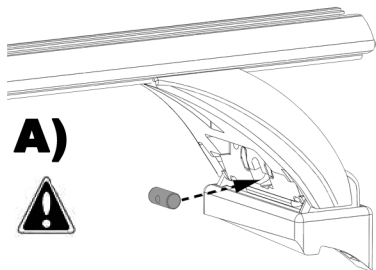

**B)**

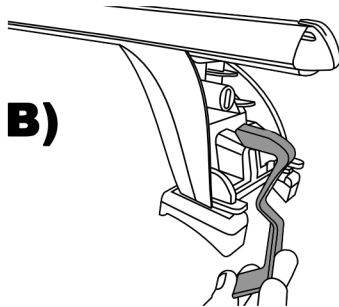

**C)**

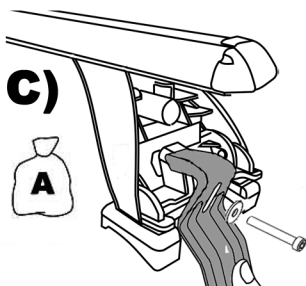

**D)**

**x2**

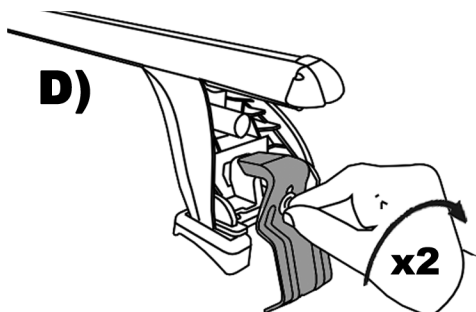

**6**

**x2**

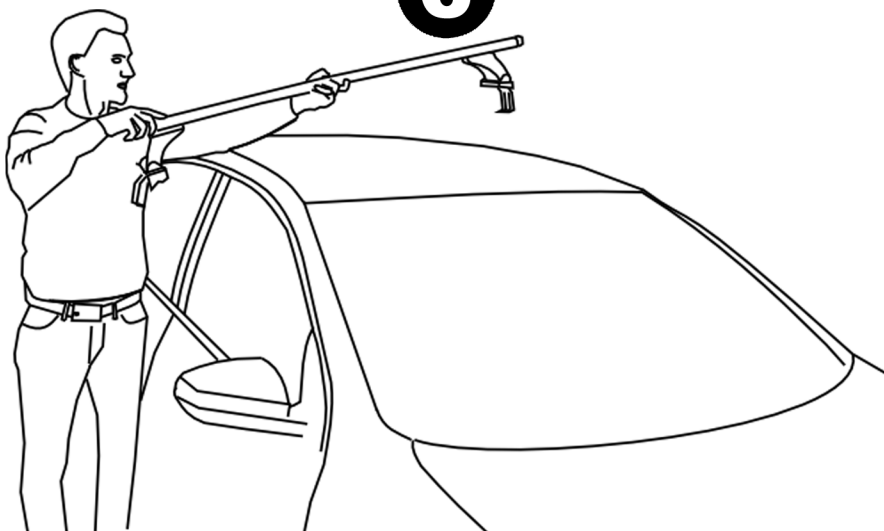

**7**

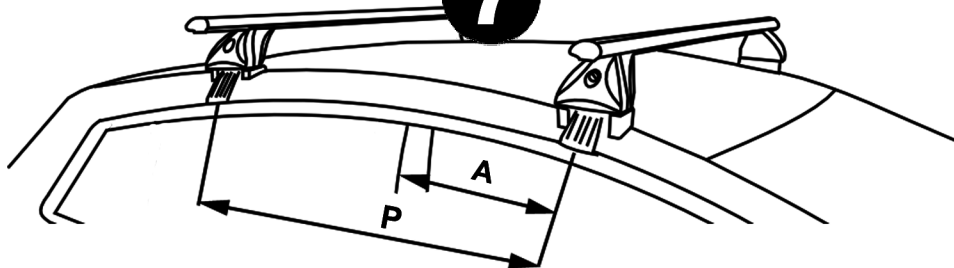

	A	P
Rav4 07->13	15 cm	70 Cm
Rav4 13 ->	15 cm	65 Cm

**x4**

**A)**

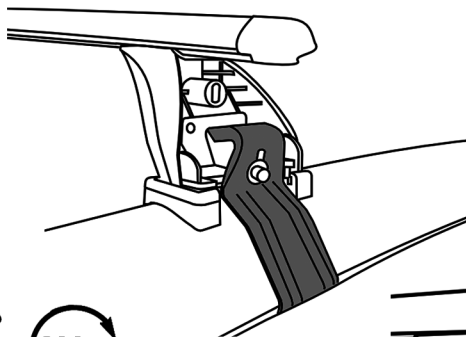

**6Nm**

**B)**

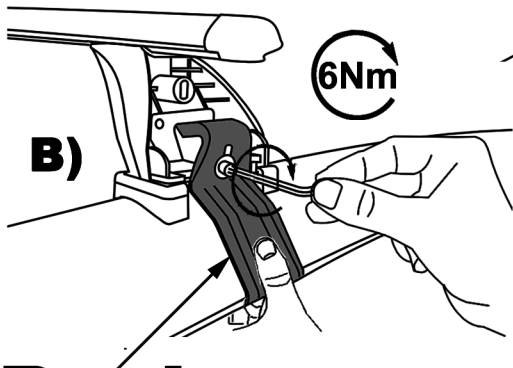

**C)**

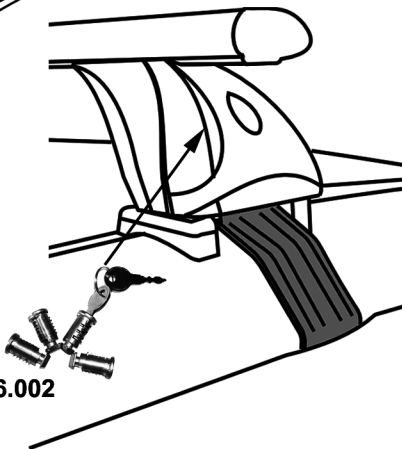

**Push**

**OPTION 156.002**

**F** Serrer alternativement chaque côté  
**E** Alternare il serraggio delle viti  
**I** Serrare alternativamente  
**P** Aperte alternadamente  
**GB** Tighten alternately  
**D** Die Schrauben abwechselnd anziehen

**NL** Afwisselend aan de linker en de rechterkant aandraaien  
**S** Dra åt växelvis  
**FIN** Kierrä vuorotellen  
**EST** Pinguldage vaheldumisi  
**LAT** Pievelciēt pamāšus  
**LIT** Uzskukinėkite pakaitomis  
**PL** Sruby dokrecaj naprzemiennie

**CZ** Pokretla bagaznika dokrecaj dokrecaj naprzemiennie  
**SK** Dotahujte striedavo  
**SLO** Privijajte izmenicno  
**HR** Naizmjenicno zategnite  
**HU** Egymástól függetlenül szorítandó  
**TR** Dönüsmümlü sikin

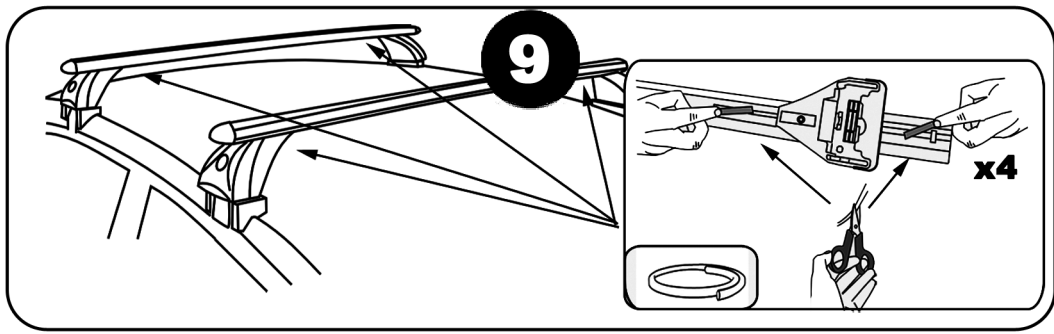
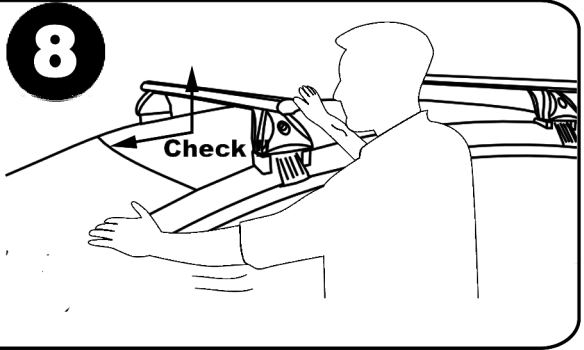
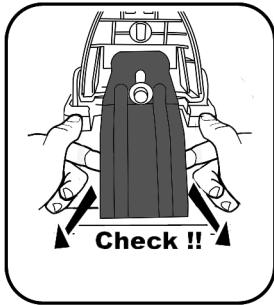

Démontage - Desmontaje - Smontaggio - Desmontagem - Disassembly - Demontage

